



Established 1859

NATIONAL DOG SHOW 2019
STAFFORDSHIRE COUNTY SHOWGROUND, WESTON ROAD, STAFFORD ST18 0BD
THURSDAY 9th - SUNDAY 12th MAY 2019
IMPORTANT INFORMATION

Please take the time to read this information carefully and study the attached plan of the showground before arriving at the show.

EXIT PASSES

All exit passes will be checked on leaving the showground. If you entered on line please print your passes before leaving home you will be unable to get dogs out of the showground without them.

Following unacceptable behaviour towards security personnel carrying out their duties on behalf of the Society, please be advised that they will wear body cams to record such behaviour.

SPECTATOR DOGS

An unentered dog tent will not be provided at the 2019 Show. Spectator dogs, from 4 months of age may be brought into the show and the fee for a Spectator dog is £5. It is essential that you collect a removal order from the Secretary's office. All dogs must have the appropriate pass to exit the showground as shown in the schedule (page 6).

CHANGE OF JUDGE TO PUBLISHED SCHEDULE

Terrier Puppy Group will now be judged by Mr John Scanlan
Working Puppy Group will now be judged by Mr Roy Baker
Miniature Pinscher will now be judged by Mrs Julie Sparrow
AV Imported Register Breeds (Day 2) (Utility & Toy) will now be judged by Mr Keith A W Young
AV Imported Register Breeds (Day 3) (Hound & Terrier) will now be judged by Mr Keith A W Young

CAR PARKING (including Disabled)

There are no car parking charges at the National Dog Show. All exhibitors have been issued with a colour coded car park label to ensure that they are parked as close to their benching area as possible, subject to the availability of space. Forward parking areas have been allocated in each of the car parks for the benefit of Disabled Exhibitors/Visitors who will be directed on the day (please ensure that the official badge is clearly displayed). **In order to assist the car-parking officials in the safe and speedy parking of vehicles you are requested to ensure that your car parking label is clearly displayed in the windscreen of your vehicle PRIOR to arriving at the showground. Failure to do so may result in you being directed to an overflow car park at the far end of the showground.**

CATERING

Breakfast will be available in the Balcony Bistro from 7.30am onwards. A selection of hot & cold food will be served whilst the show is open. The bar on the balcony will be open from 11.30am to 4.30pm (NB should there be insufficient demand the bar will close at 3.00pm).

CARAVAN SITE

As the schedule for the National Dog Show states caravans will only be allowed on the site from 10.00am. on Tuesday 6th May. Exhibitors are asked not to arrive prior to this time to allow adequate time for preparation of the site. Dogs must be kept on a lead at all times and any fouling removed immediately and placed in the wheeled skips provided. All caravans must carry their own fire extinguisher.

No motorhomes or caravans can be parked on the dog show car park overnight. One-night parking is allowed on the caravan site, subject to spaces being available. There is no pre-booking unless for the duration of the show. One-night bookings are taken on arrival, subject to space being available, the fee must be paid to the caravan warden when the space is allocated.

EYE TESTING SESSIONS & MICROCHIPPING

Lorna Newman BVMS, Cert V Ophthal, MRCVS will be holding eye-testing sessions under the KC/BVA/ISDS scheme and microchipping. She will be available from 9.30am until 3pm each day. No appointment necessary. Please remember to bring along the dog's KC registration document. Please note that as these sessions are held within the precincts of the show only dogs entered at the show (including Not for Competition/Spectator Dogs) may be tested. Gonioscopy testing may be available depending on demand on the day.

CAGES AND BLOCKING OF GANGWAYS

As per recent Kennel Club regulations, all cages when being used off the bench must have an identifying label with the exhibitor's number clearly marked

It is essential that all gangways and areas around the rings (except those designated for grooming or storage) are kept clear of any obstructions e.g. rugs, umbrellas, cages, trolleys and other equipment that are potentially hazardous. The observance of this requirement will be closely monitored. All Group Stewards have been instructed to advise the Show Management where exhibitors persist in blocking gangways or other areas. The Show Management will have no hesitation in halting judging in any ring if exhibitors persist in blocking gangways or other areas around the show rings.

VIDEO RECORDING

It is acceptable to video a general overview of the show and to video the performance of your own dogs. It is also acceptable to video other exhibitors and their dogs provided that consent is given. However, it cannot be considered to be good practice to seek to video where consent has not been given and/or where such recording is clearly unwelcome and unwanted. This would apply equally whether the person is an exhibitor or otherwise. Should the use of a video become invasive and unwelcome then the user must abide by any request or direction to cease. Any commercial filming or video recording is NOT allowed within the confines of the show without express permission of the Show Management.

NO SMOKING

Please note that in line with current legislation the Staffordshire County Showground is a **NO-SMOKING** venue and **THIS INCLUDES THE OUTDOOR PAVILIONS**.

FOULING BY DOGS

In accordance with KC Rules & Regulations Owners/Exhibitors are required to remove immediately any fouling caused by their dog(s) and/or any grooming waste within the licensed venue and within the environs including car and caravan parks and approaches.

SEMINAR – AN INTRODUCTION TO DOG SHOWING

A short seminar will be held (Thursday – Saturday inclusive) commencing at 2.15pm. Anyone interested in taking part should report to the Secretary's office at 2pm

KENNEL CLUB "HAVE A GO DOG SHOW"

A "Have a Go Dog Show will be held at 2pm on Sunday 12th May. Booking must be made through the Kennel Club web site.

PLEASE NOTE IT IS NOT ACCEPTABLE TO CLEAR UP AFTER YOUR DOGS AND THEN TO LEAVE THAT WASTE FOR SOMEONE ELSE TO PLACE IN THE WHEELED SKIPS/BINS PROVIDED. CONCERN HAS BEEN EXPRESSED BY THE OWNERS OF THE SHOWGROUND AT THE AMOUNT OF BAGGED WASTE LEFT BEHIND ON THE SITE AND THE SITUATION WILL BE CLOSELY MONITORED. THE SOCIETY RESERVES TO ITSELF THE RIGHT TO REFUSE FUTURE ENTRIES FROM ANY PERSON NOT COMPLYING WITH THIS REGULATION.

PLEASE NOTE DOGS WILL BE RECEIVED AT ANY TIME BUT IT IS THE EXHIBITOR'S RESPONSIBILITY TO ENSURE THAT EXHIBITS ARE AVAILABLE FOR JUDGING WHEN REQUIRED. The Show Management retain the right on the day to move a breed to another ring should circumstances require. The 'not before' judging time will still apply. PROPOSED JUDGING ORDER IS AS FOLLOWS (shown as number of exhibits/entries).

N.B. Wherever possible, dogs are benched in the area immediately behind their breed judging ring. In order to facilitate this, the numbering of the benching will not always run in strict numerical order.

NATIONAL DOG SHOW 2019

Day 1 : THURSDAY 9th MAY – WORKING & PASTORAL

Start times: Judging starts at 9 am. in all rings unless otherwise stated

*Non CC breed Entry figures are given as number of dogs/entries

PAVILION A

Ring 1 – Boxer 158 (164)

Ring 2 – German Shepherd Dog 78 (80) followed by Finnish Lapphund 25 (28) not before 12 noon

Ring 3 – Great Dane 62 (67) followed by Bullmastiff 46 (53) followed by Neapolitan Mastiff* 5 (5)

Ring 4 – Rottweiler 88 (92) followed by Mastiff 22 (24) followed by Tibetan Mastiff 33 (38)
followed by Great Swiss Mountain Dog* 5 (5)

Ring 5 – Dobermann 87 (94) followed by German Pinscher* 11 (11)

Ring 6 – Siberian Husky 67 (71) followed by Hovawart* 5 (6) followed by Greenland Dog* 6 (6)

ANNEXE 1

Ring 7 – Pyrenean Mountain Dog 33 (40) followed by Portuguese Water Dog 28 (29) not before 10.30am
followed by Komondor* 0 (0)

Ring 8 – Polish Lowland Sheepdog 17 (17) followed by Swedish Vallhund 23 (23) not before 10am
followed by Canadian Eskimo Dog* 12 (12) not before 11.00am

ANNEXE 2

Ring 9 – Giant Schnauzer 21 (21) followed by Australian Cattle Dog 11 (9) not before 10am
followed by Hungarian Puli 22 (22) followed by Estrela Mountain Dog* 7 (7)

Ring 10 – BSD (Malinois) 15 (17) followed by BSD (Tervueren) 23 (25)
followed by Russian Black Terrier* 21 (22)

BINGLEY HALL

Ring 11 – Alaskan Malamute 49 (59) followed by Briard 23 (25) followed by BSD (Groenendael) 25 (24)

Ring 12 – Old English Sheepdog 43 (43) followed by Maremma Sheepdog* 5 (5) followed by BSD (Laekenois)* 2 (2)
followed by Pyrenean Sheepdog (Long Haired)* 10 (9)

Ring 13 – Newfoundland 67 (76) followed by Norwegian Buhund 21 (21) not before 12 noon

Ring 14 – Grooming

Ring 15 – Dogue De Bordeaux 43 (50) followed by St. Bernard 30 (29)

Ring 16 – Bearded Collie 73 (87)

Ring 17 – Bernese Mountain Dog 63 (70) followed by Australian Shepherd 43 (46)

followed by Catalan Sheepdog (Gos d'Atura)* 12 (13) followed by Anatolian Shepherd Dog* 7 (7)
followed by Turkish Kangal Dog* 2 (3)

Ring 18 – Shetland Sheepdog 144 (162)

PRESTWOOD

Ring 19 – Collie (Rough) 98 (113) followed by Collie (Smooth) 38 (38) not before 12 noon

Ring 20 – Leonberger 50 (53) followed by Bouvier des Flandres 8 (8) followed by Lancashire Heeler 31 (33)
followed by AV Imported Reg. (Working & Pastoral) 31 (34)

ARGYLE

Ring 21 – Samoyed 42 (45) followed by Beauceron* 18 (19) not before 11.00am

Ring 22 – Welsh Corgi (Cardigan) 35 (38) followed by Welsh Corgi (Pembroke) 44 (47) not before 10.30am

SANDYLANDS

Ring 23 – Border Collie 104 (118)

Ring 24 – not in use

BEST IN SHOW RING

8.30 am start YKC Members Stakes (Working & Pastoral) 0 (14)

YKC Handling Classes 6-11 years 0 (6), 12-17 years 0 (8), 18-24 years 0 (2)

Adult Handling 17-30 years 0 (0), 31-45 years 0 (3), 46-60 0 (5), years 60+ years 0 (4)

Higham Press Post Graduate Stakes 0 (27) **10.30am approx**

Eukanuba Puppy Stakes 0 (60) **11.15am approx**

Meriel Hathaway Memorial Open Stakes 0 (17) **12.30pm approx**

Eukanuba Champion Stakes 0 (42) **1.30pm approx**

Any Variety Good Citizen Stakes 0 (47) – Special Events Ring (outside) if wet inside ring will be announced. **Not before 2.00 pm**

Breeder Group **approx 3pm**

Special Beginners Group to follow Breeders Group

Pre-judging Puppy Group – Bingley Hall **4pm approx**

Pre-judging Veteran Group – Bingley Hall **4pm approx**

NATIONAL DOG SHOW 2019

Day 2 : FRIDAY 10th MAY – UTILITY & TOY

Start times: Judging starts at 9 am. in all rings unless otherwise stated

***Non CC breed** Entry figures are given as number of dogs/entries

PAVILLION A

- Ring 1 Akita 39 (39) followed by Dalmatian 119 (141) not before 10.30am
- Ring 2 Bulldog 106 (109) followed by Japanese Akita Inu* 17 (18) not before 12 noon
- Ring 3 French Bulldog 154 (178)
- Ring 4 Keeshond 38 (38) followed by Poodle (Toy) 30 (30) followed by Eurasier* 11 (16)
- Ring 5 Chow Chow 51 (54) followed by Poodle (Standard) 46 (52) followed by Poodle (Miniature) 51 (56)
- Ring 6 Tibetan Terrier 91 (98) followed by Japanese Shiba Inu 42 (43) not before 12 noon

ANNEXE 1

- Ring 7 Lowchen 26 (25) followed by Chihuahua (Long Coat) 106 (125) not before 10.00am
- Ring 8 Chihuahua (Smooth Coat) 93 (103) followed by Yorkshire Terrier 53 (54)

ANNEXE 2

- Ring 9 Griffon Bruxellois 44 (45) followed by Maltese 35 (42)
- Ring 10 German Spitz (Klein) 40 (41) followed by German Spitz (Mittel) 39 (38)

BINGLEY HALL

- Ring 11 Havanese 54 (60) followed by English Toy Terrier 52 (56)
- Ring 12 Affenpinscher 58 (60) followed by Pekingese 34 (37)
- Ring 13 Lhasa Apso 71 (72) followed by AV Import Reg (Utility & Toy) 41 (48) not before 11.30am
- Ring 14 Pomeranian 107 (123)
- Ring 15 Cavalier King Charles Spaniel 167 (191)
- Ring 16 Japanese Spitz 58 (59) followed by Boston Terrier 76 (81)
- Ring 17 Italian Greyhound 30 (35) followed by Schipperke 35 (36) followed by Bolognese* 25 (25) not before 12 noon
- Ring 18 **8.30am Start** Japanese Chin 101 (106) followed by King Charles Spaniel 59 (68)
followed by Coton de Tulear* 46 (44)

MARGARET EVERTON BUILDING

- Ring 18A Chinese Crested 73 (85) followed by Chinese Crested Club Championship Show

PRESTWOOD

- Ring 19 Schnauzer 31 (32) followed by Tibetan Spaniel 100 (107) not before 10.30am
- Ring 20 Papillon 119 (123)

ARGYLE

- Ring 21 Shih Tzu 84 (90) followed by Australian Silky Terrier* 6 (6) not before 12 noon
- Ring 22 Shar Pei 26 (27) followed by Miniature Schnauzer 89 (92) followed by Canaan Dog* 7 (6)
followed by Koikerhondje* 24 (26)

SANDYLANDS

- Ring 23 Pug 127 (133)
- Ring 24 Bichon Frise 46 (43) followed by Miniature Pinscher 57 (60) not before 11.00am

BEST IN SHOW RING

- 8.30 am start** YKC Members Stakes (Utility & Toy) 0 (14)
- YKC Handling Classes 6-11 years 0 (0), 12-17 years 0 (3), 18-24 years 0 (2)
- Adult Handling 17-30 years 0 (3), 31-45 years 0 (5), 46-60 years 0 (6), 60+ years 0 (4)
- Higham Press Post Graduate Stakes 0 (43) **10.30am approx**
- Eukanuba Puppy Stakes 0 (102) **11.15am approx**
- Meriel Hathaway Memorial Open Stakes 0 (29) **12.30pm approx**
- Eukanuba Champion Stakes 0 (43) **1.30pm approx**
- Any Variety Good Citizen Stakes 0 (39) – Special Events Ring (outside) if wet inside ring will be announced. **Not before 2.00 pm**
- Breeder Group **approx 3pm**
- Special Beginners Group to follow Breeders Group
- Pre-judging Puppy Group – Bingley Hall **4pm approx**
- Pre-judging Veteran Group – Bingley Hall **4pm approx**

NATIONAL DOG SHOW 2019

Day 3 : SATURDAY 11th MAY - HOUND & TERRIER

Start times: Judging starts at 9 am. in all rings unless otherwise stated

***Non CC breed** Entry figures are given as number of dogs/entries

PAVILION A

- Ring 1 Afghan Hound 86 (79)
Ring 2 Basset Fauve De Bretagne 45 (44) followed by Pharaoh Hound 24 (23) followed by Ibizan Hound 16 (18) followed by Sloughi* 4 (4)
Ring 3 Beagle 114 (125) followed by Hamiltonstovare* 8 (8) not before 12 noon
Ring 4 Otterhound 23 (22) followed by Basset Griffon Vendéen (Grand) 27 (26) not before 10.00am followed by Basset Griffon Vendéen (Petit) 38 (38) not before 11.00am followed by Cirneco Dell' Etna* 16 (16)
Ring 5 Irish Wolfhound 33 (33) followed by Borzoi 29 (29) followed by Basenji 37 (36) not before 11.00am followed by AV Import Reg (Hound & Terrier) 11 (12) not before 12.30pm
Ring 6 Deerhound 52 (53) followed by Saluki 43 (43) followed by Bloodhound 8 (8) not before 10.30am followed by Finnish Spitz 14 (15) not before 12 noon

ANNEXE 1

- Ring 7 Dachshund (Miniature Long-Haired) 86 (94) followed by Dachshund (Miniature Smooth-Haired) 122 (133)
Ring 8 Dachshund (Wire Haired) 57 (60)

ANNEXE 2

- Ring 9 Basset Hound 58 (58) followed by Dachshund (Long-Haired) 44 (47)
Ring 10 Dachshund (Smooth-Haired) 40 (40) followed by Dachshund (Miniature Wire-Haired) 84 (87) followed by Portuguese Podengo* 25 (24)

BINGLEY HALL

- Ring 11 Rhodesian Ridgeback 119 (133)
Ring 12 Welsh Terrier 20 (19) followed by Norwegian Elkhound 24 (26) not before 10.00am followed by Greyhound 18 (17) not before 11.00am followed by Foxhound* 2 (2)
Ring 13 Whippet 197 (213)
Ring 14 Fox Terrier (Smooth) 32 (36) followed by Manchester Terrier 34 (36) followed by Soft Coated Wheaten Terrier 60 (58) not before 11.30am
Ring 15 Border Terrier 133 (152)
Ring 16 Airedale Terrier 30 (31) followed by Kerry Blue Terrier 21 (21) followed by Fox Terrier (Wire) 24 (24) followed by Jack Russell Terrier* 50 (58)
Ring 17 West Highland White Terrier 72 (72) followed by Norfolk Terrier 34 (39) not before 11.30am
Ring 18 Australian Terrier 16 (16) followed by Lakeland Terrier 19 (21) followed by Norwich Terrier 24 (25) followed by Scottish Terrier 40 (38)

PRESTWOOD

- Ring 19 Glen of Imaal Terrier 6 (6) followed by Bedlington Terrier 38 (41) not before 9.30am followed by Cesky Terrier 29 (29)
Ring 20 Irish Terrier 26 (28) followed by Parson Russell Terrier 52 (54) not before 10am followed by Sealyham Terrier 24 (22) not before 12 noon

ARGYLE

- Ring 21 Skye Terrier 23 (23) followed by Cairn Terrier 50 (50) followed by Dandie Dinmont Terrier 32 (36)
Ring 22 Bull Terrier 41 (42) followed by Bull Terrier (Miniature) 33 (34)

SANDYLANDS

- Ring 23 Staffordshire Bull Terrier 107 (112)

BEST IN SHOW RING

- 8.30 am start** YKC Members Stakes (Hound & Terrier) 0 (23)
YKC Handling Classes 6-11 years 0 (12), 12-17 years 0 (8), 18-24 years 0 (5)
Adult Handling 17-30 years 0 (8), 31-45 years 0 (1), 46-60 years 0 (6), 60+ years 0 (10)
Higham Press Post Graduate Stakes 0 (52) **10.30am approx**
Eukanuba Puppy Stakes 0 (95) **11.15am approx**
Meriel Hathaway Memorial Open Stakes 0 (29) **12.30pm approx**
Eukanuba Champion Stakes 0 (35) **1.30pm approx**
Any Variety Good Citizen Stakes 0 (41) – Special Events Ring (outside) if wet inside ring will be announced. **Not before 2.00 pm**
Breeder Group **approx 3pm**
Special Beginners Group to follow Breeders Group
Pre-judging Puppy Group – Bingley Hall **4pm approx**
Pre-judging Veteran Group – Bingley Hall **4pm approx**

NATIONAL DOG SHOW 2019

Day 4 : SUNDAY 12th MAY – GUNDOG

Start times: Judging starts at 9 am. in all rings unless otherwise stated

***Non CC breed** Entry figures are given as number of dogs/entries

PAVILION A

- Ring 1 German Shorthaired Pointer 84 (95)
- Ring 2 Gordon Setter 85 (91) followed by Spaniel (Irish Water) 20 (24) not before 11am followed by the IWS Open Show
- Ring 3 Retriever (Chesapeake Bay) 34 (44) followed by German Wirehaired Pointer 42 (42)
followed by Lagotto Romagnolo* 34 (35)
- Ring 4 Italian Spinone 79 (80) followed by GWP Club Open Show
- Ring 5 Retriever (Flat Coated) 126 (147)
- Ring 6 Retriever (Labrador) 152 (196)

ANNEXE 1

- Ring 7 Spaniel (American Cocker) 49 (55) followed by Irish Red & White Setter 36 (36) not before 10.30am
- Ring 8 Kennel Club "Have a Go Dog Show"

ANNEXE 2

- Ring 9 Spaniel (Cocker) 117 (140) followed by Large Munsterlander 46 (54)
followed by German Longhaired Pointer* 11 (11)
- Ring 10 Grooming

BINGLEY HALL

- Ring 11 Spaniel (English Springer) 69 (72) followed by Spaniel (Sussex) 29 (30)
- Ring 12 Bracco Italiano 51 (56) followed by retriever (Curly Coated) 32 (31)
- Ring 13 Retriever (Golden) 204 (263)
- Ring 14 Grooming
- Ring 15 Irish Setter 154 (194)
- Ring 16 Grooming
- Ring 17 English Setter 81 (93) followed by AV Import Reg (Gundog) 27 (28), RARE BREEDS MATCH
- Ring 18 Hungarian Wirehaired Vizsla 50 (53) followed by Hungarian Vizsla 77 (94) not before 10.30am

PRESTWOOD

- Ring 19 Spaniel (Welsh Springer) 85 (94)
- Ring 20 Weimaraner 91 (110)

ARGYLE

- Ring 21 Retriever (Nova Scotia Duck Tolling) 67 (90)
- Ring 22 Spaniel (Clumber) 26 (26) followed by Spanish Water Dog 29 (37)
followed by Spaniel (Field) 33 (40) not before 11am followed by Brittany 30 (28)

SANDYLANDS

- Ring 23 Pointer 117 (136)

BEST IN SHOW RING

- 8.30 am start** YKC Members Stakes (Gundog) 0 (14)
- YKC Handling Classes 6-11 years 0 (7), 12-17 years 0 (1), 18-24 years 0 (7)
- Adult Handling 17-30 years 0 (6), 31-45 years 0 (5), 46-60 years 0 (4), 60+ years 0 (1)
- Higham Press Post Graduate Stakes 0 (45) **10.30am approx**
- Eukanuba Puppy Stakes 0 (63) **11.15am approx**
- Meriel Hathaway Memorial Open Stakes 0 (22) **12.30pm approx**
- Eukanuba Champion Stakes 0 (36) **1.30pm approx**
- Any Variety Good Citizen Stakes 0 (46) – Special Events Ring (outside) if wet inside ring will be announced. **Not before 2.00 pm**
- Breeder Group **approx 3pm**
- Special Beginners Group to follow Breeders Group
- Pre-judging Puppy Group – Bingley Hall **4pm approx**
- Pre-judging Veteran Group – Bingley Hall **4pm approx**

NATIONAL DOG SHOW 2019

Staffordshire County Showground, Weston Road, Stafford ST18 0BD

Disabled Parking for Pavilion A & Sandylands Centre, Argyle Centre & Prestwood Centre

Sandylands Centre

Argyle Centre

BLUE CAR PARK

Parking for Sandylands Centre, Argyle Centre & Prestwood Centre

Prestwood Centre

Officials, Judges, Disabled Parking for Bingley Hall & Annexe 1 & 2 Exhibitors

Margaret Everton Building

grandstand Barn Cafe

catering

Pavilion A

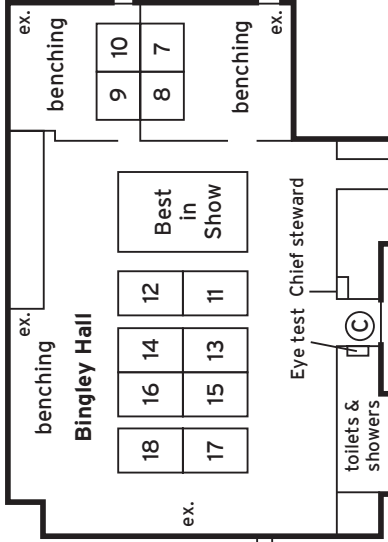
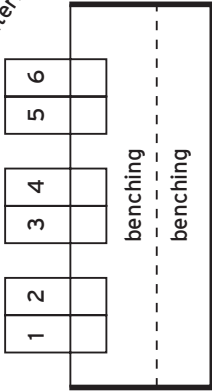

Annexe 2

Annexe 1

Secretary, Treasurer, Higham Press

Stewards' reception (NatWest Suite)

Judges' reception (President's Suite)

WHITE CAR PARK

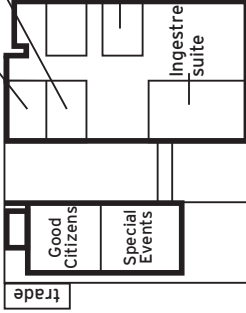

Key: (C) Catalogues

ex. Exercise areas
wc Toilets

GREEN CAR PARK

Parking for Bingley Hall & Annexe 1 & 2

YELLOW CAR PARK

Entrance

Parking for Pavilion A